

William Sharpe

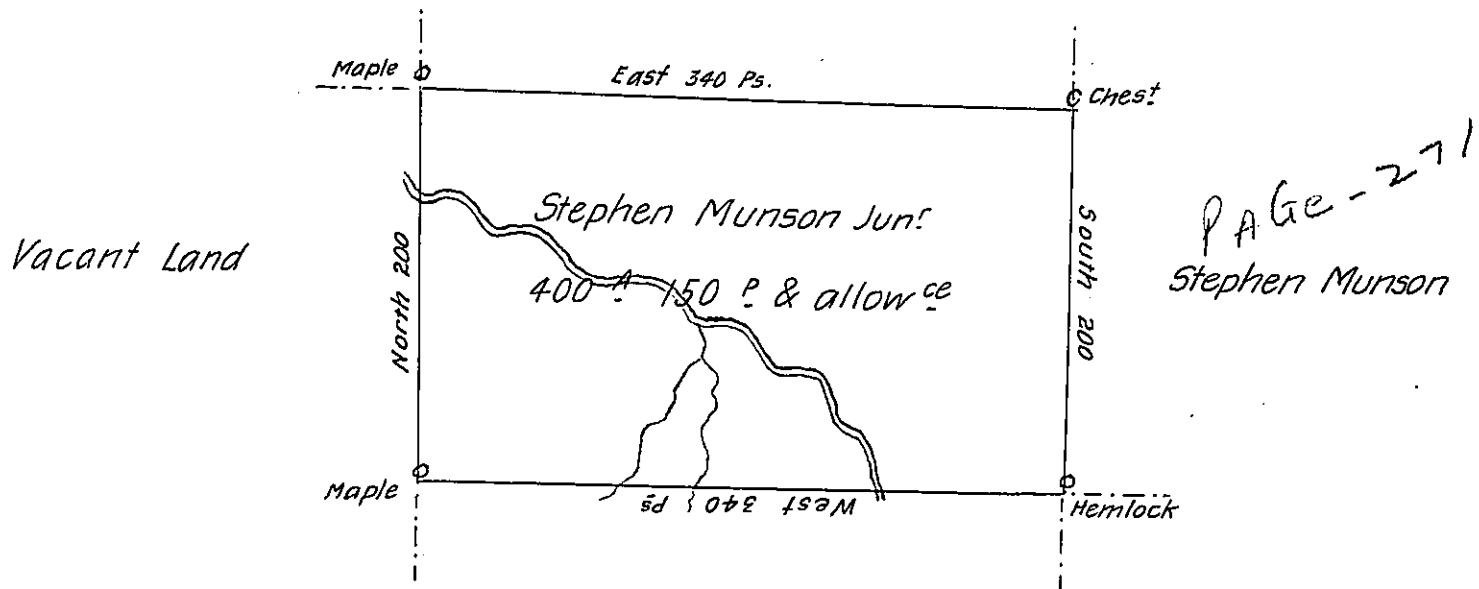

Daniel Sumnerlin

A Draught of a Tract of land Situate in the Coubl. of Luzerne
 Containing Four hundred Acres, 150 perches & Allow^{ce} of six P. C^t for
 roads &c. Surveyed Aug^t 8th 1793 on a warrant to Stephen Munson Jun^r
 dated the 13th Aug^t 1792.

Taken from the field Notes of Joseph J. Wallis then Deputy Sur-
 veyor

Henry Donnel D.S.

To Dan^l Brodhead Esq^r
 Surveyor General

Certified this 8th feby 1802

Tho^s Sambourne Dy. Sr.

IN TESTIMONY that the above is a copy of the original remaining on file in
 the Department of Internal Affairs of Pennsylvania, made
 conformably to an Act of Assembly approved the 16th day of
 February, 1833, I have hereunto set my Hand and caused
 the Seal of said Department to be affixed at Harrisburg,
 this first day of December 1905

George D. ...
 Secretary of Internal Affairs.